



1-piece system

FLEXIMA[®] ACTIVE

FEEL THE DIFFERENCE

Flexima[®] Active

Closed and drainable Roll'Up bags

High performance filter

- Leak-Proof and permeable to gases high-tech breathable membrane

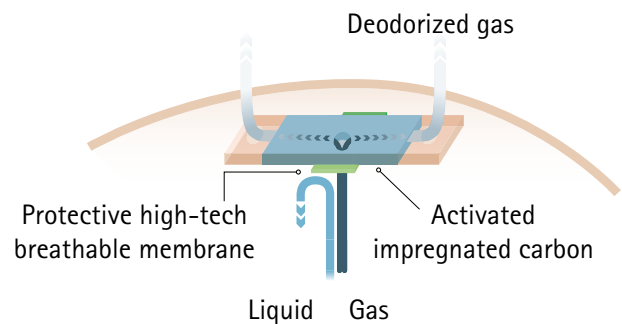

Compact shape

Closed bags

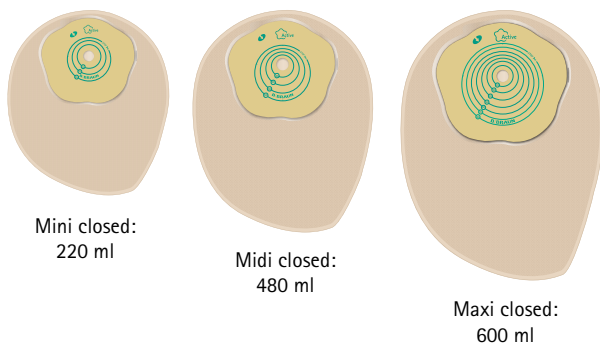

Drainable bags with integrated Roll'Up clamp

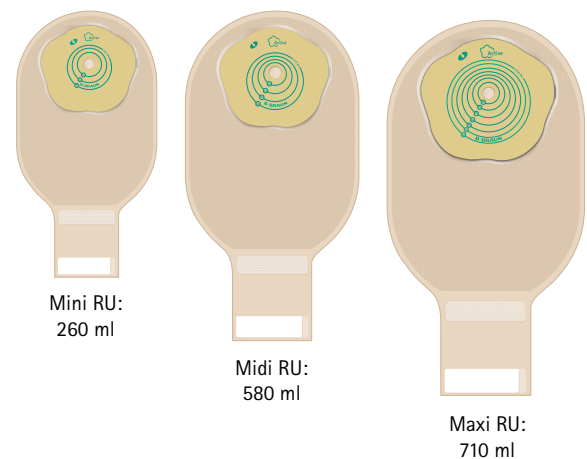

- Ergonomic shape
- Optimized sizing
- 3 sizes available: mini/midi/maxi

Intuitive and secure closing system

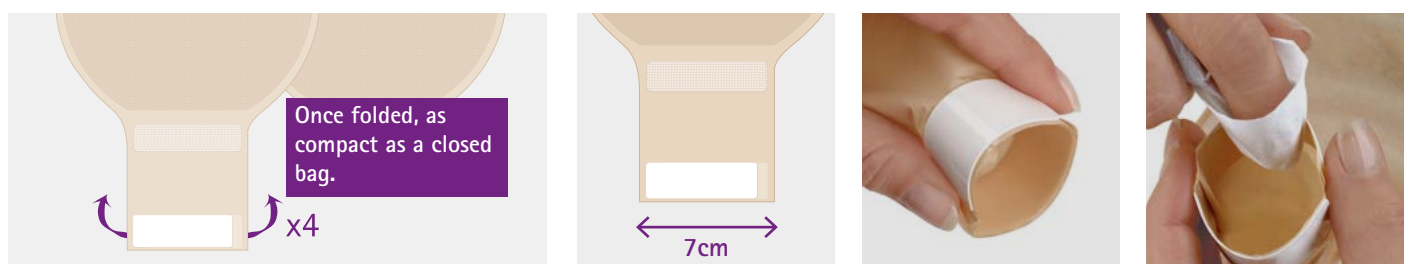

- Soft edges
- A large 7cm outlet for both colostomates and ileostomates
- White opening tabs

Flexima[®] Active

A B. Braun patented skin protector to feel the difference

A highly cohesive network

- The tack: **immediate adhesivity**
- High wearing **comfort***
- **Low risk** of residue**

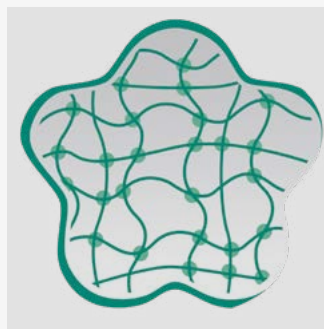

A patented copolymers formula

Second skin sensation*

- One piece **low profile system***
- **Adapts** to body contours*
- Skin **preservation****

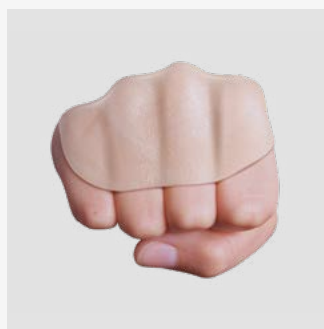

Inspection window

This inspection window combines both:

- the discretion of a beige bag
- the visual control of both stoma and output (in both post-op phases and everyday life)
- for an easier patient education

Available on both closed & drainable bags.

A new step towards self confidence!

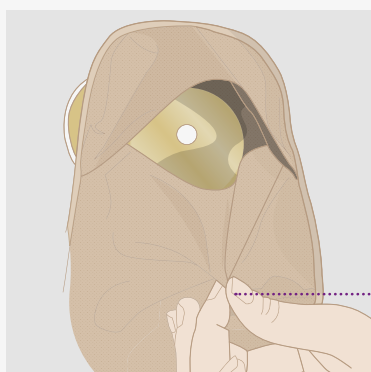

- Visual control of the stoma at any time
- Check stool aspect
- Check quantity of output

« Great comfort while wearing and so soft that I can forget I'm having a bag.»

Richard. 58 Years Old. Ileostomate. France

« Appreciated for its adaptability to the skin, ease of application, comfort, discretion and easy removal, leaving no residues.»

Lina. Enterostomal Therapist (ET) Nurse. Italy

*International Post Market User Evaluation of Flexima[®] / Softima[®] Active 1-Piece system – B. BRAUN Internal Report

** Study code: IDEA 2.60_12 J

Flexima® Active

FLEXIMA® ACTIVE CLOSED FLAT - BOX OF 30

Size	∅ (mm)	References	Volume
Mini	✂️ 15-45	● 4612215	±220ml
		○ 4611115	
Midi	✂️ 15-50	● 4612115	±480ml
		● 4610125	
		● 4610130	
		● 4610135	
		● 4610140	
Maxi	✂️ 15-65	● 4612380	±600ml
		○ 4611380	

FLEXIMA® ACTIVE ROLL'UP FLAT - BOX OF 30

Size	∅ (mm)	References	Volume
Mini	✂️ 15-45	● 4622215	±260ml
		● 4620215	
		○ 4621215	
Midi	✂️ 15-50	● 4622115	±580ml
		● 4620115	
		○ 4621115	
		● 4620125	
		● 4620130	
Maxi	✂️ 15-65	● 4620135	±710ml
		● 4620140	
		● 4622380	
		● 4620380	
		○ 4621380	

✂️ Cut-to-fit | ● Beige | ○ Transparent | ● Beige with inspection window
 For most countries a specific letter is added at the end of the radical reference

This document, its contents, including institutional data, information, trademarks and logos mentioned herein are the exclusive property of B. Braun. Any representation and / or reproduction, total or partial, of this document and its contents without the express prior consent of B. Braun, is strictly prohibited and constitutes an infringement of the intellectual property rights of B. Braun.

Commercialized and manufactured by :
 B. Braun Medical SAS | 26 rue Armengaud | 92210 Saint-Cloud - France
 Tél. 01 41 10 53 00 | Fax 01 70 83 45 00 | www.bbraun.fr | www.bbraun.com
 Societ  par Actions Simplifi e with a share capital of 31 000 000   | RCS Nanterre 562050856



All stoma bags volumes are measured according to ISO 8670-2 standard.
 This medical device is a regulated health care product and on the basis of this regulation is certified CE.
 The products commercialized by B. BRAUN MEDICAL shall exclusively be used in accordance with the package inserts which have been updated and included in the boxes.
 Non binding documents and photographs

www.bbraun.com/living-with-a-stoma